



Observers Training



Kelly Clifton, PhD
Andréa Livi
Daniel Rodríguez, PhD



Session Outline

- Introduction
- Street Segments & Survey Procedure
- Detailed Description of Each Question
- Practice Segments
- Discussion & Conclusion

Street Segments and Survey Procedure

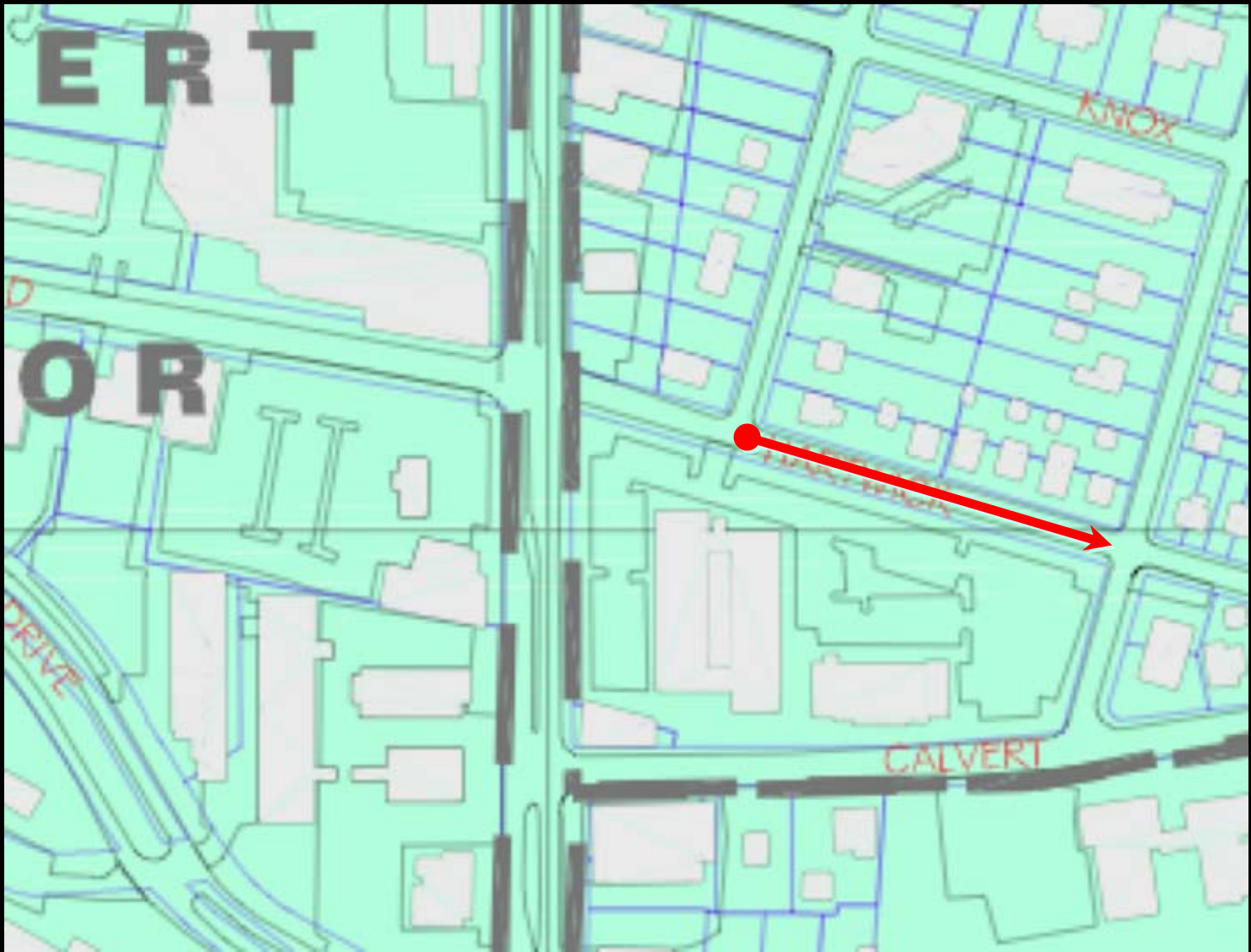

Segment ID#	Street Name	Street Type	FRADDL	TOADDL	FRADDR	TOADDR	Length	Surveyed
1	Amherst	Rd	4750	4798	4709	4799	85	
2			0	0	0	0	346	
3	Amherst	Rd	0	0	4703	4707	220	
4	Rhode Island	Ave	6700	6798	6701	6799	329	
5	Amherst	Rd	4700	4748	0	0	38	
6	Darthmouth	Ave	6800	6818	6801	6819	43	
7	Darthmouth	Ave	6820	6898	6821	6899	169	
8			0	0	0	0	123	
9	Queens Chapel	Rd	6712	6714	0	0	276	
10	Baltimore	Ave	6762	6798	6763	6799	366	
11	Pineway		6800	6820	6715	6813	211	
12	Baltimore	Ave	6800	6898	6801	6899	257	
13	Beechwood	Rd	4500	4598	4501	4599	398	
14	Rhode Island	Ave	6800	6898	6801	6899	365	
15	Beechwood	Rd	4408	4410	4411	4415	214	
16	Rhode Island	Ave	6900	6906	6901	6903	297	
17	Wake Forest	Dr	6900	6902	0	0	357	
18	Clemson	Rd	4600	4698	4601	4699	627	
19	Baltimore	Ave	6900	6906	6901	6905	402	
20	Drexel	Rd	4800	4898	4801	4899	287	
21	Drexel	Rd	4710	4798	4711	4799	371	
22	Rhode Island	Ave	6908	6998	6905	6999	304	
23	Wake Forest	Dr	6904	6998	6901	6999	329	
24	Drexel	Rd	4600	4698	4601	4699	686	
25	Baltimore	Ave	6908	6998	6907	6999	291	
26	Carleton	Ter	6900	6998	6901	6999	686	
27	Darthmouth	Ave	7000	7002	7001	7003	235	
28	Erskine	Rd	4800	4898	4801	4899	545	
29	Bowdoin	Ave	7000	7098	7001	7099	123	
30	Rhode Island	Ave	7000	7096	7001	7005	255	
31	Darthmouth	Ave	7004	7098	7005	7099	73	
32	Fordham	Rd	4612	4698	4615	4699	213	
33	Wake Forest	Dr	7000	7006	7001	7005	255	
34	Fordham	Rd	4600	4610	4601	4613	473	
35	Bowdoin	Ave	7100	7198	7101	7199	113	
36	Pineway		0	0	6931	6933	227	
37	The Mews		0	0	0	0	611	
38			0	0	0	0	359	

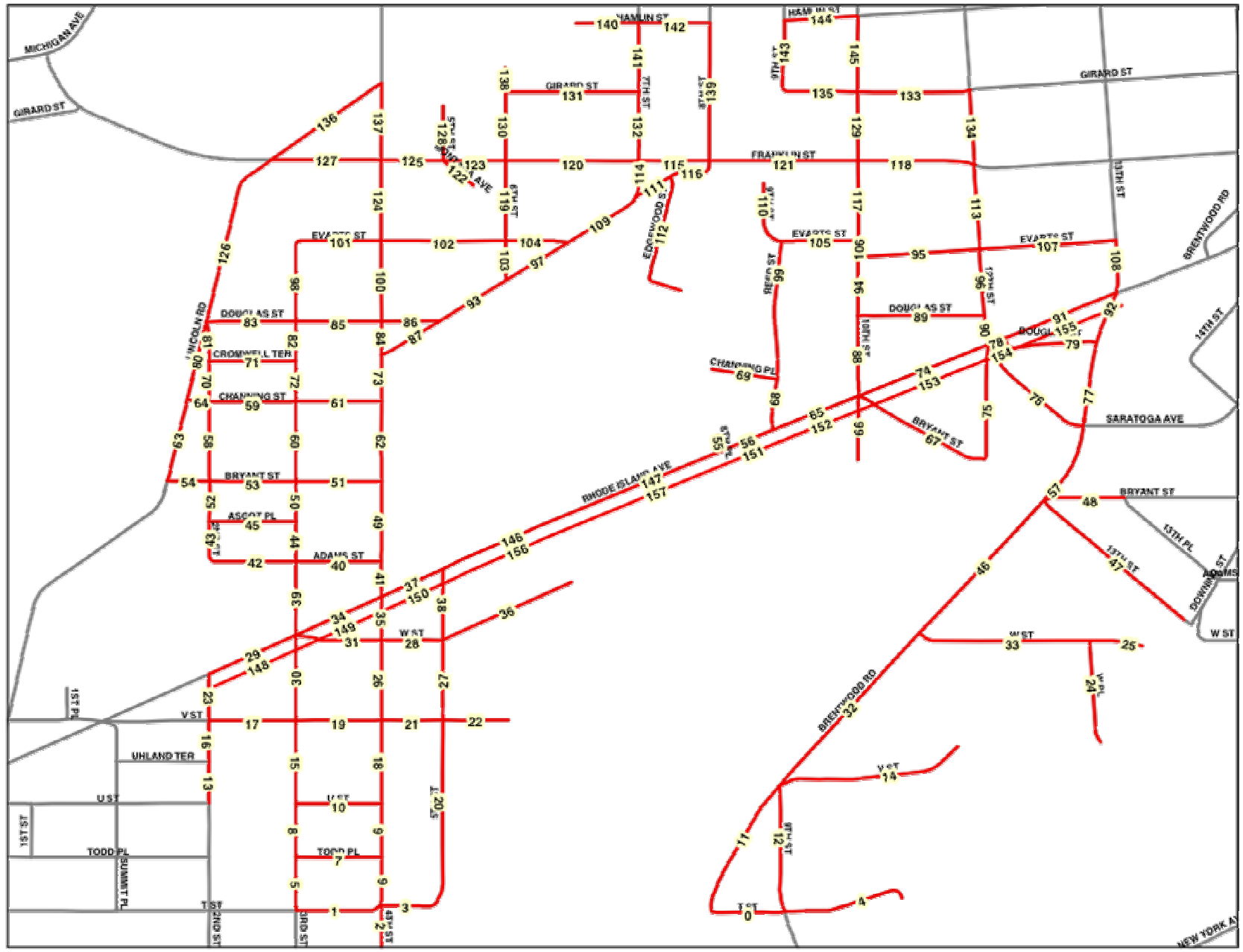

NEW YORK AV

Detailed Description of Each Question

Questionnaire Sections

- ID Info
- Section O: Segment Type
- Section A: Environment
- Section B: Pedestrian Facility
- Section C: Road Attributes
- Section D: Walking/Cycling Environment
- Section SA: Subjective Assessment

Question 0

Type of Segment

- Low Volume Road
- High Volume Road
- Pedestrian Path

UNIV
O
MARY

TERRAPIN TRAIL

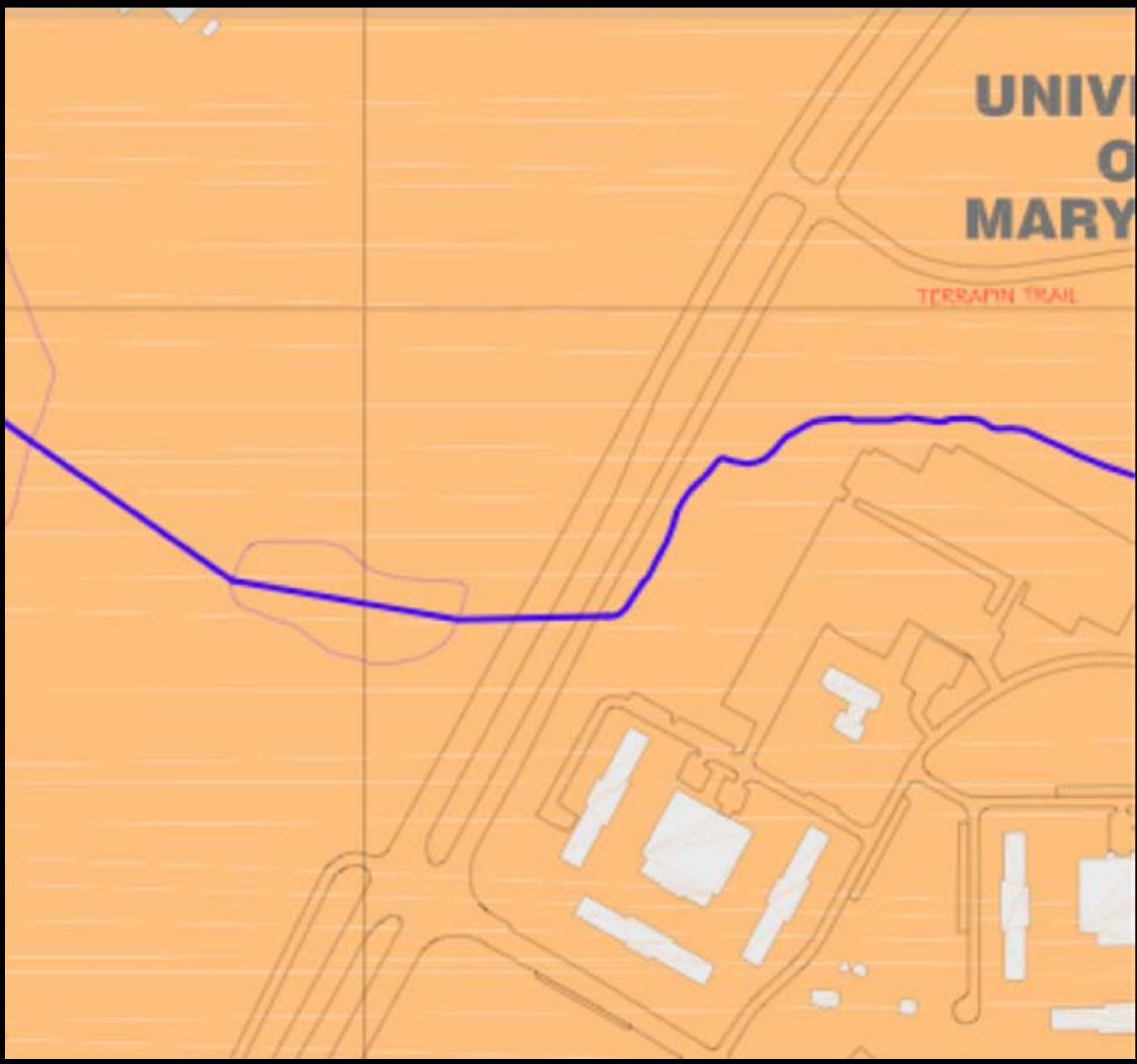

Section A: Environment

Question 1

Types of Buildings/Features

- Housing - Single Family
- Housing - Multi Family
- Housing - Mobile Home
- Office/Institutional
- Commercial/Restaurant
- Industrial
- Vacant/Undeveloped
- Recreation

check all that apply

Q1 - Types of Buildings/Features

Single Family Multi Family



Q1 - Types of Buildings/Features

Mobile Homes



Q1 - Types of Buildings/Features

Office/Institutional

Commercial



Q1 - Types of Buildings/Features

Vacant

Recreation



Question 2

Slope

- Flat
- Slight Hill
- Steep Hill

Q2 - Slope Flat



Q2 - Slope Slight Hill



Q2 - Slope Steep Hill





Question 3

Segment Intersections

- Segment has 3 way intersection
- Segment has 4 way intersection
- Section has other intersection
- Section has deadend, but path continues
- Segment has deadend
- Segment has no intersections

check all that apply

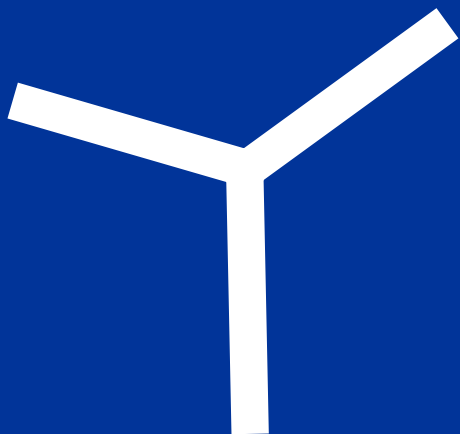
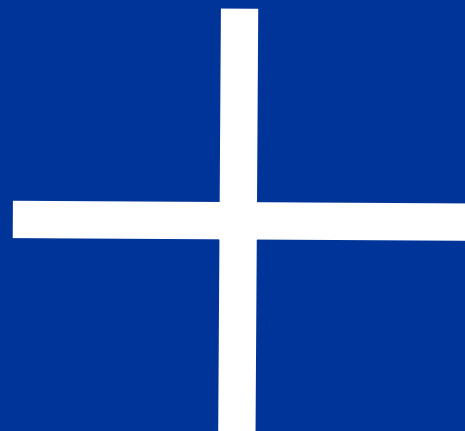
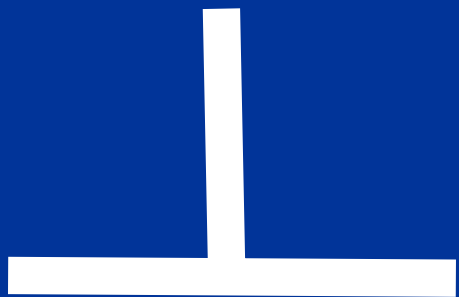



Section B: Pedestrian Facility

Note: skip if none present

Question 4

Type(s) of Pedestrian Facility

- Footpath (worn dirt path)
- Paved Trail
- Sidewalk
- Pedestrian Street (closed to cars)

Q4 - Pedestrian Facility No Path



Q4 - Pedestrian Facility Trail/Footpath



Q4 - Pedestrian Facility Paved Trail



Q4 - Pedestrian Facility Sidewalk



Q4 - Pedestrian Facility Pedestrian Street



NOTE:

The rest of the questions in section B refer to the BEST pedestrian facility in the segment.

Question 5

Path Material

- Asphalt
- Concrete
- Paving Bricks or Stone
- Gravel
- Dirt or Sand

check all that apply

Q5 - Path Material Asphalt



Q5 - Path Material Concrete



Q5 - Path Material Paving Bricks or Stone



Q5 - Path Material Gravel



Q5 - Path Material Dirt or Sand



Question 6

Path Condition/Maintenance

- Poor (many bumps, cracks, holes and weeds)
- Fair (some bumps, cracks, holes and weeds)
- Good (very few bumps, cracks, holes and weeds)
- Under Repair

Q6 - Path Condition/Maintenance Poor



Q6 - Path Condition/Maintenance Fair



Q6 - Path Condition/Maintenance Good



Question 7

Path Obstructions

- Poles or Signs
- Parked Cars
- Trees/Greenery
- Garbage Cans
- Other
- None

check all that apply

Q7 - Path Obstructions



Question 8

Buffers Between Road and Path

- Fence
- Trees
- Hedge
- Landscape
- Grass
- None

check all that apply

Q8 - Buffers

Fence



Hedges



Q8 - Buffers

Landscape



Grass



Q8 - Buffers Trees and Grass



Question 9

Path Distance from Curb

- At Edge
- < 5 feet
- > 5 feet

Q9 - Distance from Curb



Question 10

Sidewalk Width

- < 4 feet
- 4 to 8 feet
- > 8 feet

Q10 - Sidewalk Width



Question 11

Curb Cuts

- None
- 1 to 4
- More than 4

Q11 - Curb Cuts



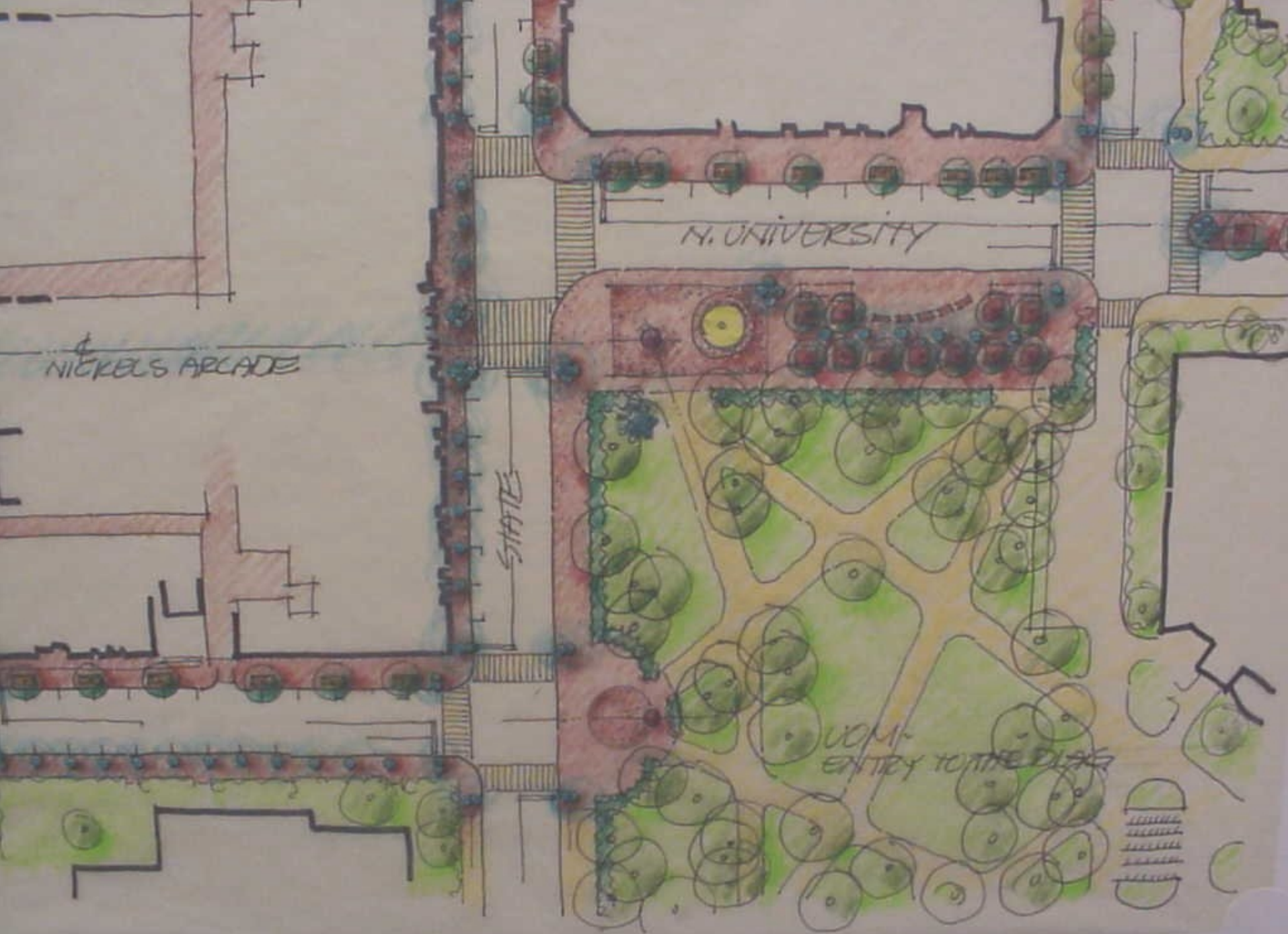

N. UNIVERSITY

NICKELS ARCADE

STATE

UOM -
ENTRY TO THE CLASS

Question 12

Sidewalk Completeness/Continuity

- Sidewalk is Complete
- Sidewalk is Incomplete

Q12 - Sidewalk Completeness/Continuity



A complete sidewalk is one that does not end **WITHIN** the segment that is being observed.

This sidewalk is incomplete.



Question 13

Connectivity to Other Sidewalks

- Number of Connections _____

Q13 - Sidewalk Connectivity

The number of connections the segment has to crosswalks and other sidewalks

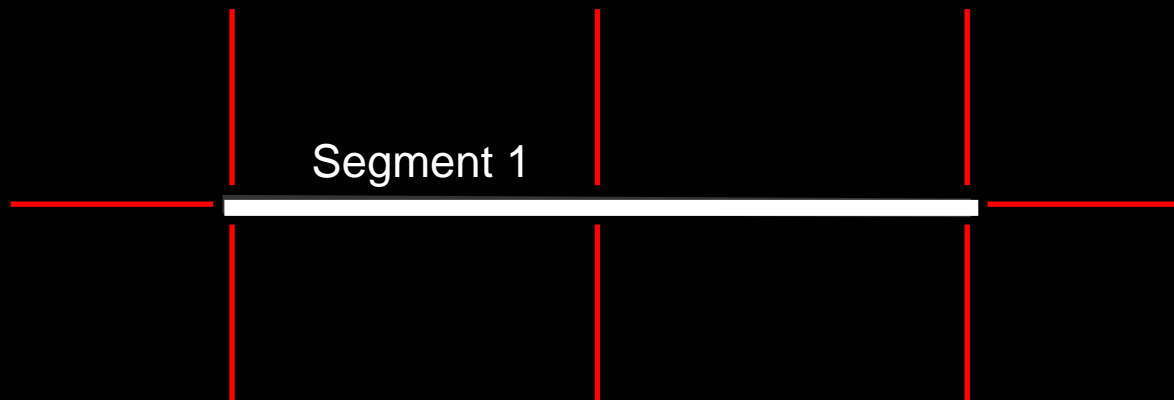

Q13 - Sidewalk Connectivity

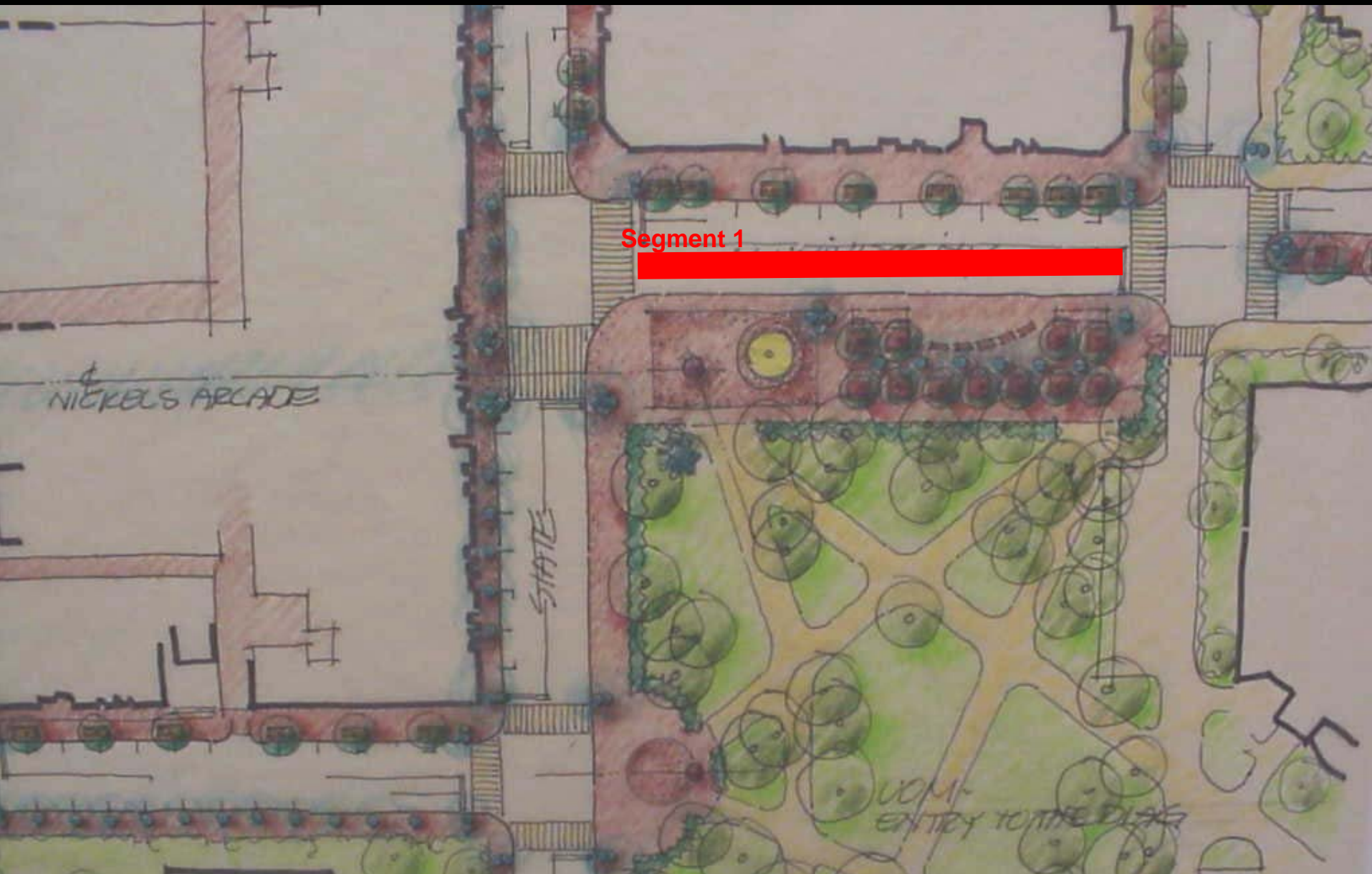

Section C: Road Attributes

(Skip if ped path only)

Question 14

Road Condition

- Poor (many bumps, cracks and holes)
- Fair (some bumps, cracks and holes)
- Good (very few bumps, cracks and holes)
- Under Repair

Q14 - Road Condition Poor



Q14 - Road Condition Fair



Q14 - Road Condition Good



Question 15

Number of Lanes

- Minimum number of lanes to cross _____
- Maximum number of lanes to cross _____

Q15 - Number of Lanes to Cross



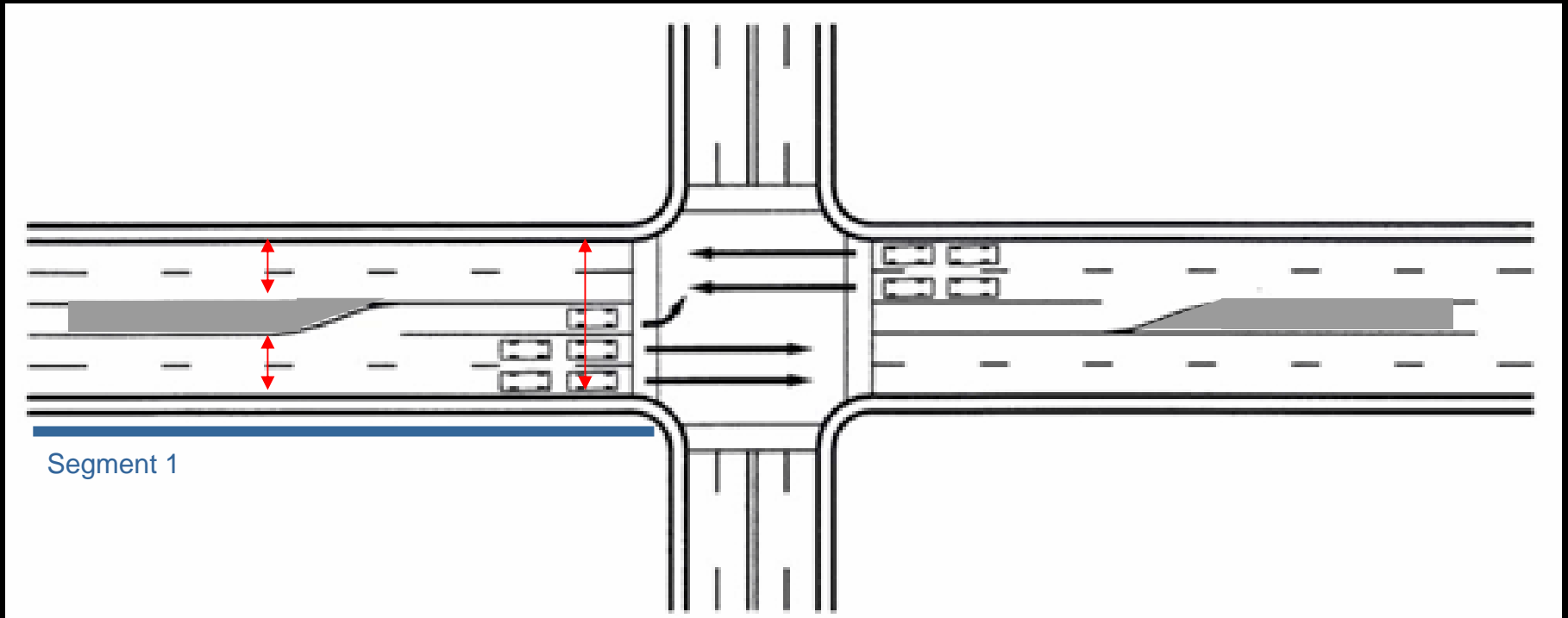

Minimum lanes to cross: 4

Maximum lanes to cross: 5

Question 16

Posted Speed Limit in Segment

- No Speed Limit Posted
- Posted Speed Limit (in mph) _____

SPEED

LIMIT

30

Question 17

On Street Parking

- Parallel or Diagonal
- None

Note: If pavement is unmarked, check only if cars are parked

Q17 - On Street Parking

Parallel

Diagonal



Question 18

Off Street Parking Spaces

0-5	6-25	26+



Question 19

Do you have to walk through a parking lot to get to most buildings?

- Yes
- No



Question 20

Presence of med-hi volume driveways

- < 2
- 2 to 4
- > 4

Q20 - Driveways



Q20 - Driveways



Question 21

Traffic Control Devices

- Traffic Light
- Stop Sign
- Traffic Circle
- Speed Bump
- Chicane or Choker
- None

check all that apply

Q21 - Traffic Control Devices:

Traffic Light

Stop Sign



Q21 - Traffic Control Devices: Traffic Circle Speed Bump



Q21 - Traffic Control Devices: Chicane



Choker



Question 22

Crosswalks

- None
- 1 to 2
- 3 to 4
- > 4



Question 23

Crossing Aids

- Yield to pedestrian paddle
- Pedestrian Signal
- Median/Traffic Island
- Curb Extension
- Overpass/Underpass
- Pedestrian Crossing Street Sign
- Flashing Warning
- Share the Road Sign
- None

check all that apply

Q23 - Crossing Aids: Yield to Ped Paddle



Q23 - Crossing Aids: Pedestrian Signal



Q23 - Crossing Aids:

Median/Traffic Island

Curb Extension



Q23 - Crossing Aids: Overpass



Q23 - Crossing Aids:

Ped Crossing Street Sign

Flashing Warning



Question 24

Bicycle Facilities

- Bicycle Route Sign
- Striped Bicycle Lane Designation
- Visible Bicycle Parking Facility
- Bicycle Crossing Warning
- None

check all that apply



Q24 - Designated Bikeway



Section D:
Walking/Cycling Environment

Question 25

Roadway/Path Lighting

- Road-oriented Lighting
- Pedestrian Scale Lighting
- Other Lighting
- No Lighting

Streetlights



Question 26

Amenities

- Garbage Cans
- Bench
- Water Fountain
- Street Vendor/Vending Machine
- None

check all that apply



Question 27

Presence of Wayfinding Aids

- No
- Yes

MAPLE AVE. S101

CENTER DR. W250

VERNON TOWN HALL

Question 28

Number of Trees Shading Walking Area

- None or Very Few
- Some
- Many/Dense

Q28 - Number of Trees: None or Very Few



Q28 - Number of Trees: Some



Q28 - Number of Trees: Many/Dense



Question 29

Degree of Enclosure

- Little or No Enclosure
- Some Enclosure
- High Enclosure

Q29 - Degree of Enclosure: Little or none



Q29 - Degree of Enclosure: Some enclosure



Q29 - Degree of Enclosure: High Enclosure



Question 30

Powerlines Along Segment

- Low Voltage/Distribution Line
- High Voltage/Transmission Line
- None

Q30 - Powerlines Along Segment:

High Voltage Low Voltage



Question 31

Overall Cleanliness and Building Maintenance

- Poor (much litter/graffiti/broken facilities)
- Fair (few litter/graffiti/broken facilities)
- Good (no or almost no litter/graffiti/broken facilities)

Q31 - Cleanliness: Poor



Q31 - Cleanliness: Fair



Q31 - Cleanliness
Good

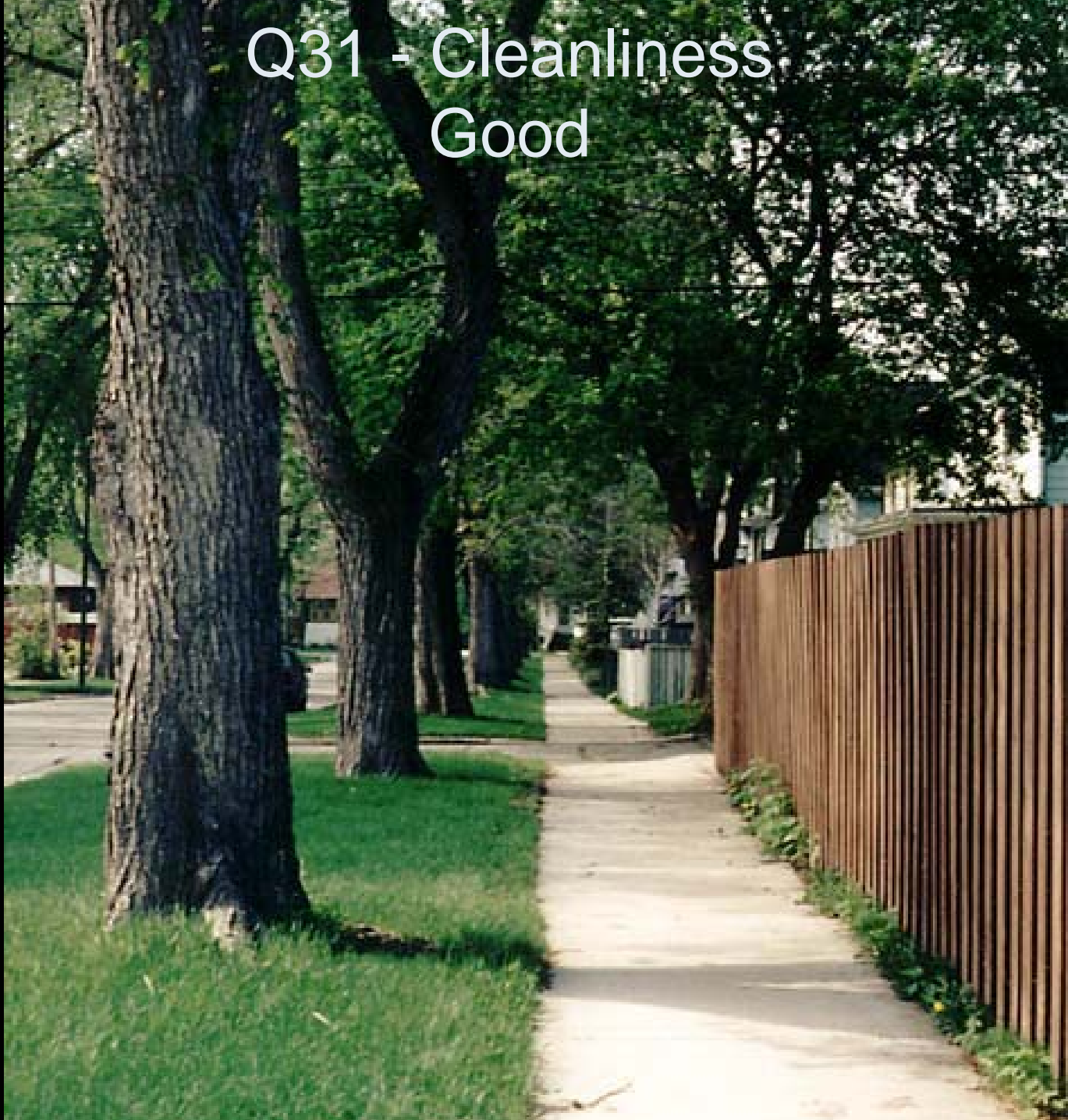



Question 32

Articulation

- Little or No Articulation
- Some Articulation
- High Articulation

Q32 - Building Articulation: Little or No Articulation



Q32 - Building Articulation: Some Articulation



Q32 - Building Articulation: Highly Articulated









Question 33

Building Setbacks from Sidewalk

- At Edge of Sidewalk
- Within 20 feet of Sidewalk
- More than 20 feet from Sidewalk

Q33 - Building Setback: At Edge of Sidewalk



Q33 - Building Setback: Within 20 Feet of Sidewalk



Q33 - Building Setback: More than 20 Feet from Sidewalk



Question 34

Building Height

- Short
- Medium
- Tall

Q34 - Building Height: Short



Q34 - Building Height: Medium



Q34 - Building Height: Tall









Question 35

Bus Stops

- Bus Stop with Shelter
- Bus Stop with Bench
- Bus Stop with Sign Only
- None

Q35 - Transit Facilities: Shelter



Q35 - Transit Facilities: Bus stop with bench



Q35 - Transit Facilities: Bus stop with sign only



Section SA: Subjective Assessment

Scale

1 = Strongly Agree

2 = Agree

3 = Disagree

4 = Strongly Disagree

Subjective Questions

- Segment is Attractive for Walking
- Segment is Attractive for Cycling
- Segment is Safe for Walking
- Segment is Safe for Cycling













2000. 4. 14













Practice Segments

Segment 1

Segment 2

Segment 3

Segment 4

Segment 5

Segment 6

Segment 7



Q & A

Conclusion

Special Thanks to Suzanne Akkoush for her assistance and to Reid Ewing & Otto Clemente for use of their street segment movies.

Some photographs used courtesy of www.pedbikeimages.org

